

32 Portland Place, Frome, Somerset, BA11 4LT

Sold @ Auction £112,000



- FOR SALE BY ONLINE AUCTION
- WEDNESDAY 13TH APRIL 2022
- VIDEO TOUR NOW ONLINE
- VIEWINGS - REFER TO DETAILS
- DOWNLOAD ONLINE LEGAL PACKS
- APRIL 2022
- 1 BED LEASEHOLD FLAT
- FIRST FLOOR (438 Sq Ft)
- REQUIRES UPDATING
- EXTENDED 8 WEEK COMPLETION

Hollis Morgan – APRIL LIVE ONLINE AUCTION - A leasehold FIRST FLOOR PURPOSE BUILT FLAT (439 Sq Ft) now in need of BASIC UPDATING but with scope for HOME or INVESTMENT in this central location

Accommodation

Floor plan

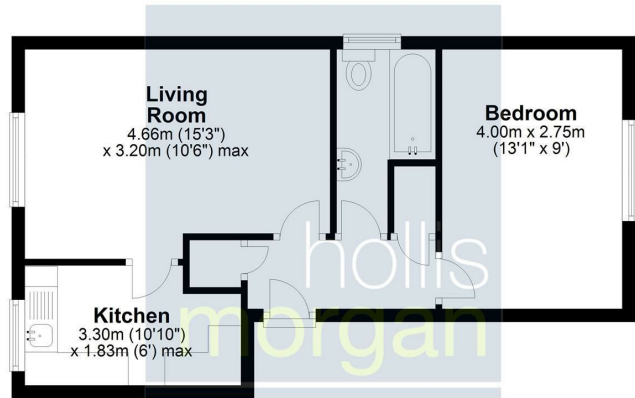

Total area: approx. 40.7 sq. metres (438.3 sq. feet)

Illustration for identification purposes only, measurements are approximate, not to scale.

Plan produced using PlanUp.

EPC Chart

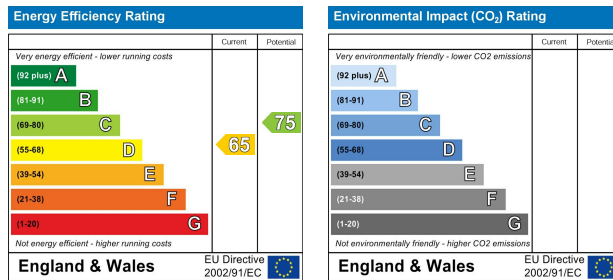

9 Waterloo Street

Clifton

Bristol

BS8 4BT

Tel: 0117 973 6565

Email: post@hollismorgan.co.uk

www.hollismorgan.co.uk

Hollis Morgan Property Limited, registered in England, registered 7275716.

Registered address, 5 Upper Belgrave Road, Clifton, Bristol BS8 2XQ

Auction Property Details Disclaimer

Hollis Morgan endeavour to make our sales details clear, accurate and reliable in line with the Consumer Protection from Unfair Trading Regulations 2008 but they should not be relied on as statements or representations of fact.

Please refer to our website for further details.